



## Broad Oaks Close

Harpenden, AL5 2PR

Beautifully presented, five bedroom detached home of circa 3,237 sq ft, situated in a peaceful cul-de-sac in the highly sought-after West Common area. Principal suite with dressing room and en-suite and four generous reception rooms. Mature, south-facing garden of over 100 ft, private driveway and a double garage. The property is close to the Rothamsted Estate and within easy reach of Harpenden town centre and station.

**Guide price £2,295,000**

# Broad Oaks Close

Harpenden, AL5 2PR



- Detached house
- Driveway and double garage
- Within easy reach of town centre and station
- Five bedrooms
- Peaceful cul-de-sac
- Circa 3,237 sq ft
- Mature south facing garden in excess of 100ft
- Highly sought-after West Common area
- Council tax band H

## Reception Hall

## Cloakroom

## Dining Room

15'6" x 13'4" (4.73 x 4.08)

## Living Room

20'9" x 15'5" (6.34 x 4.71)

## Study

12'5" x 10'1" (3.79 x 3.08)

## Family Room

13'5" x 12'9" (4.11 x 3.91)

## Utility Room

13'11" x 6'2" (4.24m x 1.88m)

## Kitchen/Breakfast Room

19'8" x 13'5" (6 x 4.11 )

## Landing

## Principal Bedroom

15'6" x 13'6" (4.73 x 4.14)

## Dressing Room

15'6" x 8'2" (4.73 x 2.50)

## En-suite with bath and shower

## Bathroom

## Bedroom Two

13'6" x 11'0" (4.12 x 3.37)

## En-suite with shower

## Bedroom Three

13'6" x 10'4" (4.12 x 3.16)

## Landing

## Bedroom Four

15'4" x 13'7" (4.68 x 4.16)

## Bathroom

## Bedroom Five

13'7" x 13'4" (4.16 x 4.07)

## Garage

17'10" x 16'6" (5.45 x 5.03)



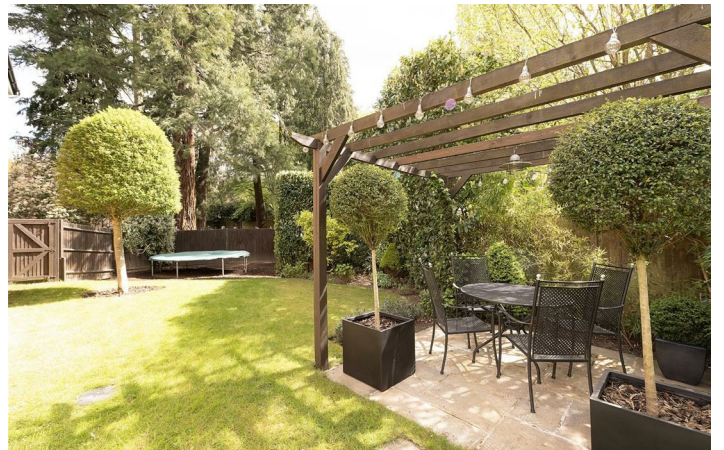

# Floor Plan

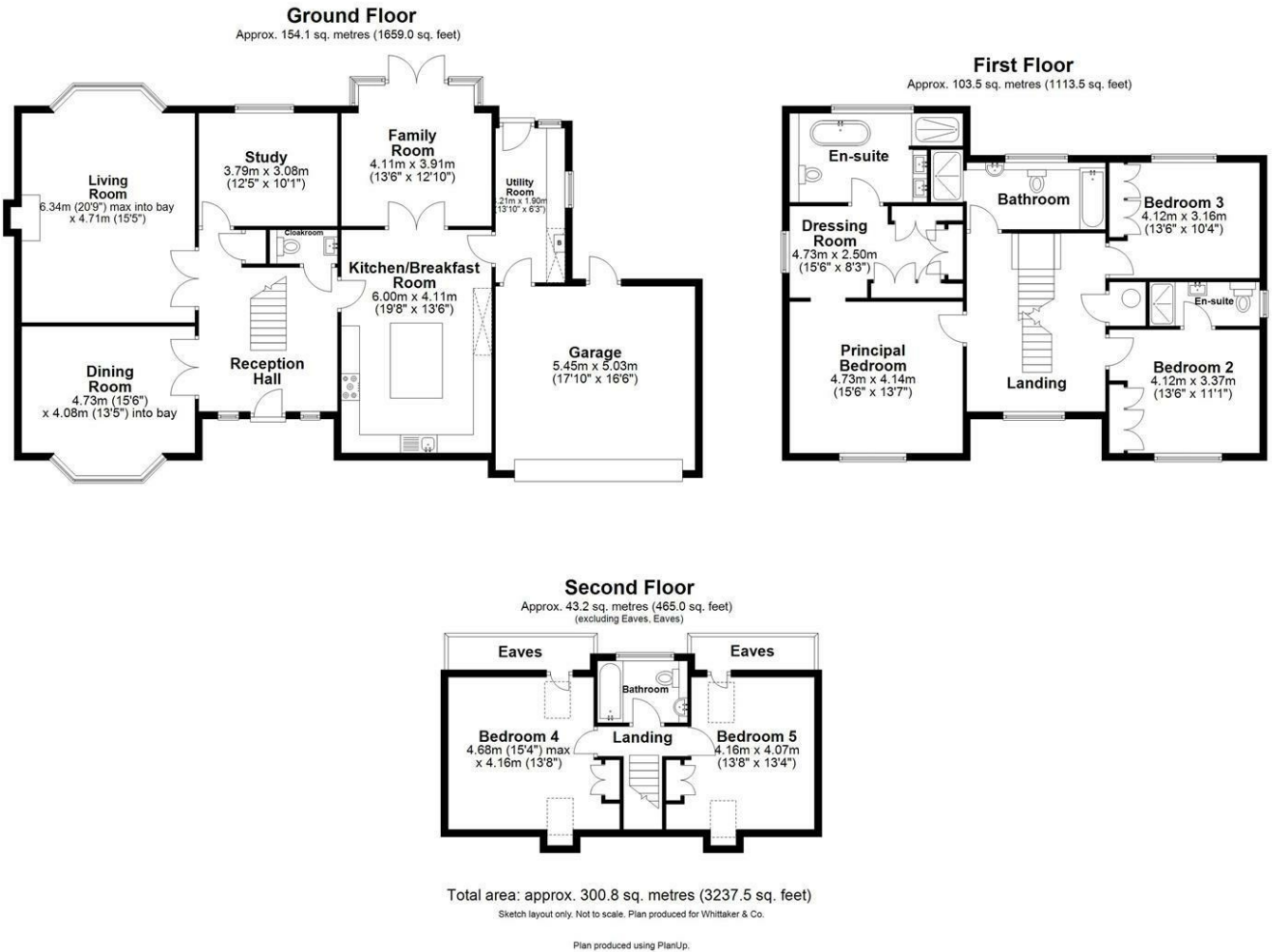

These particulars, whilst believed to be accurate are set out as a general outline only for guidance and do not constitute any part of an offer or contract. Intending purchasers should not rely on them as statements of representation of fact, but must satisfy themselves by inspection or otherwise as to their accuracy. No person in this firm's employment has the authority to make or give any representation or warranty in respect of the property.

